

Department of Engineering
Tim Bryan, P.E., PTOE, County Engineer

3137 South Liberty Street, Canton, MS 39046
Office (601) 855-5582 FAX (601) 859-5857

MEMORANDUM

December 12, 2024

To: Casey Brannon, Supervisor, District I
Trey Baxter, Supervisor, District II
Gerald Steen, Supervisor, District III
Karl Banks, Supervisor, District IV
Paul Griffin, Supervisor, District V

From: Tim Bryan, P.E., PTOE
County Engineer

Re: AT&T Utility Permit
County Road Name, Yandell Road

The Engineering Department recommends approval of the permit application for AT&T Utility to bury 1190' of fiber along the south side of Yandell Road from existing AT&T site to new site and place AT&T cabinet to service the new Woodgate Subdivision as shown on the attached plans.



PERMIT APPLICATION FOR THE CONSTRUCTION OR ADJUSTMENT OF A UTILITY WITHIN COUNTY ROAD RIGHT-OF-WAY

Utility Information: Utility Name: _____

Address: _____ City/State/Zip: _____

Contact Person: _____ Contact's Phone: _____

Project Information: County Road Name: _____
(If located within more than one road right-of-way, use Appendix 1 for additional descriptions)

Beginning Location: _____ Ending Location: _____

Length of Project: _____ Section: _____ Township: _____ Range: _____

Description of Work: _____

Check Box if Appendix 1 is to be included as a part of this Application

Whereas the above stated Utility makes application to the **Madison County Board of Supervisors** for a Construction Permit. Attached hereto are drawings and plans for the construction of the above facilities located within Madison County owned public rights-of-way. Once stamped by the Madison County Engineering Department, these plans shall not be changed or altered without written approval of the County Engineer, or his representative. A copy of the approved permit and plans shall be on-site at all times during construction.

The Applicant Utility shall comply with all policies, procedures and construction practices as outlined in *A Policy for The Accommodation of Utility Facilities within the Right-of-Way of all Public County Roads* (hereinafter referred to as the "Policy"), as adopted on November 1, 2005, by the **Madison County Board of Supervisors**, and which is hereby made a part of this Application Agreement.

If facilities are to be located within the Rights-of-Way of the County-Federal or State Aid System, Applicant Utility also agrees to comply with applicable provisions of *S.O.P. No. SA II-2-8, Accommodation of Utilities on Rights-of-Way*, issued by the State Aid Engineer and dated July 1, 2005.

The Applicant Utility understands and agrees that, except as herein granted, no right, title, claim, or easement to said road right-of-way is granted by the issuance of this permit. If this Utility is listed in the general provisions of the Policy, it will be adjusted to comply with same without cost to the County, unless the variance from the Policy has been approved by the granting of the Permit pursuant to this Application.

The Applicant Utility further understands that the Utility's engineering, plant, or other personnel will be responsible for the staking and construction supervision of the work set out above and as shown on the attached plans. If work impacts traffic in any way, the appropriate traffic control shall be installed per the *Manual of Uniform Traffic Control Devices*, Latest Edition.

The Applicant Utility understands that the County Engineer, or his representative, may issue a Stop Work Order at any time if it is deemed that site conditions are not suitable for construction or if any of the requirements of this permit are not being met.

Many County Roads have variable Rights-of-Way and/or no Right-of-Way at all and are maintained under a Prescriptive Easement. It is the sole responsibility of the Applicant Utility to verify the existence and limits of public rights-of-way. If none exists, it is the

responsibility of the Applicant Utility to acquire an easement for their Facilities from the applicable property owner(s). Madison County in no way verifies the limits of Right-of-Way as shown on the permit application.

The Applicant Utility shall be responsible for all future maintenance and repair of the facilities installed under this permit. The Applicant Utility shall make future adjustments to, or relocate, the facilities located within road or highway right-of-way when required for road or highway widening or other road or highway construction at no cost to Madison County. The Applicant Utility shall relocate said utilities within sixty (60) days of notification by County by registered mail, return receipt requested, unless otherwise designated by the County Engineer. Further, any maintenance, repair, or construction shall be done in such a manner as to occasion no unreasonable interference with the normal flow and safety to traffic and at the expense of the utility company. When reasonable care has been taken to locate said utility facilities within the right-of-way, the Applicant Utility understands that any damages caused by routine maintenance and construction by County forces shall be borne by the Applicant Utility.

The Applicant Utility further agrees to indemnify and hold Madison County harmless for any and all claims, accidents, damages, liabilities and expenses occasioned wholly, or in part, by any act or omission of applicant, its agents or employees. In case County shall, without fault on its own part, be made a party to any litigation commenced by or against applicant, then applicant shall protect and hold County harmless, and shall pay all costs, expenses and reasonable attorney's fees incurred or paid by County in connection with said litigation.

All underground facilities shall be installed at a depth equal to or greater than 48" below the lowest adjacent grade.

All pipes carrying liquid shall be encased under County maintained roads.

WITNESS the signature of the Applicant this the _____ day of _____, 20_____.

By: DONNA E MALLER
(Applicant Signature)

Title: OSP ENGINEER

Note: *Applicant must be an employee of the Utility named in this application. The Madison County Board of Supervisors will not recognize a Contractor, Subcontractor, Agent, or Consulting Engineer as the Applicant. Utility Company shall be fully responsible for all work performed under this application.*

I, or my authorized representative, have reviewed this application and determined that the drawing, sketches, and plans submitted by the Applicant meet the requirements of *A Policy for The Accommodation of Utility Facilities within the Right-of-Way of all Public County Roads.*

By: _____
Tim Bryan, P.E.
County Engineer

AGREED TO AND APPROVED BY:

Madison County Board President

Date: _____

ENTERED INTO THE MINUTES OF THE BOARD OF SUPERVISORS OF MADISON COUNTY, MISSISSIPPI ON THIS _____ DAY OF _____, 20_____.

Appendix 1

County Road Name: _____
Beginning Location: _____ Ending Location: _____
Length of Project: _____ Section: _____ Township: _____ Range: _____
Description of Work: _____

County Road Name: _____
Beginning Location: _____ Ending Location: _____
Length of Project: _____ Section: _____ Township: _____ Range: _____
Description of Work: _____

County Road Name: _____
Beginning Location: _____ Ending Location: _____
Length of Project: _____ Section: _____ Township: _____ Range: _____
Description of Work: _____

County Road Name: _____
Beginning Location: _____ Ending Location: _____
Length of Project: _____ Section: _____ Township: _____ Range: _____
Description of Work: _____

County Road Name: _____
Beginning Location: _____ Ending Location: _____
Length of Project: _____ Section: _____ Township: _____ Range: _____
Description of Work: _____

CUSTOMER ADDRESS :
 F 100 WOODGATE BLVD, CANTON, MS 39046
 MADISON COUNTY



ISSUE	DATE
0	06-20-23

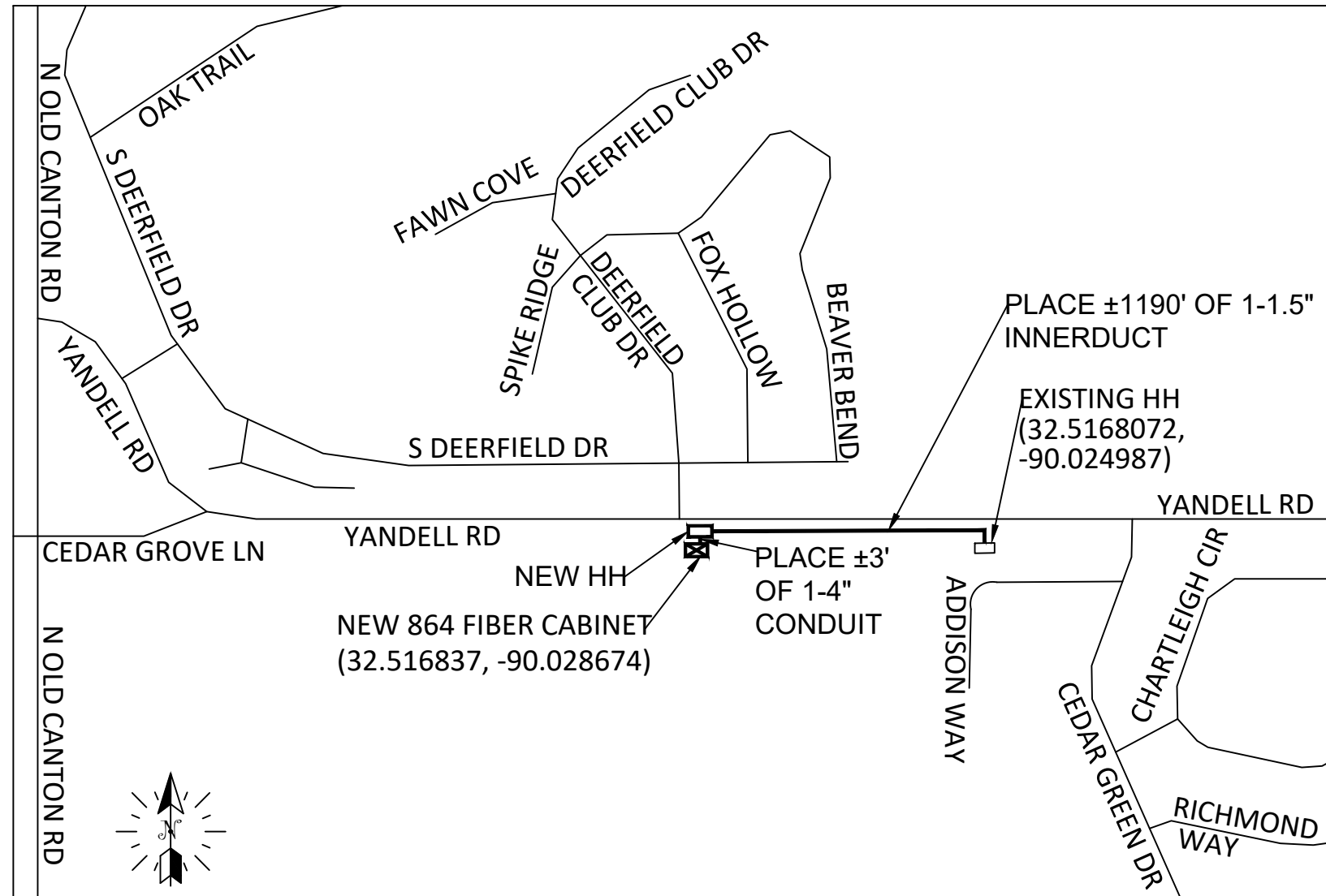

ATTSE	
PROPOSED TELEPHONE FACILITIES ON RIGHT OF WAY OF MADISON COUNTY	
F 100 WOODGATE BLVD	
NPANNX:	601856
Designer:	MIZELL DAVID
Phone:	(601) 859-3307
Authorization:	A02KKWC
Dwg. 1	of 4

CALL BEFORE YOU DIG

MISSISSIPPI
 DIAL 811 or
 1-800-432-4770
 www.call811.com

TWO FULL BUS. DAYS BEFORE YOU DIG

IT IS THE CONTRACTOR'S RESPONSIBILITY TO CONTACT UTILITY COMPANIES PRIOR TO ANY CONSTRUCTION AS THE LOCATION OF UTILITIES SHOWN ON THIS PLAN ARE APPROXIMATE AND POSSIBLY INCOMPLETE. THEREFORE CERTIFICATION TO THE LOCATION OF ALL UNDERGROUND UTILITIES IS WITHHELD.

PLACEMENT CALLOUTS

- ① DIG 4' X 4' BORE PIT-1, BORE PIT-2 & BORE PIT-3 IN DIRT SURFACE.
- ② BORE FROM EXISTING HH (BORE PIT-1) TO BORE PIT-2 AND PLACE ±40' OF 1-1.5" INNERDUCT AT DEPTH 36".
- ③ BORE FROM BORE PIT-2 TO BORE PIT-3 AND PLACE ±383' OF 1-1.5" INNERDUCT AT DEPTH 36".
- ④ BORE FROM BORE PIT-3 TO BORE PIT-4 AND PLACE ±383' OF 1-1.5" INNERDUCT AT DEPTH 36".



ISSUE	DATE
0	06-20-23

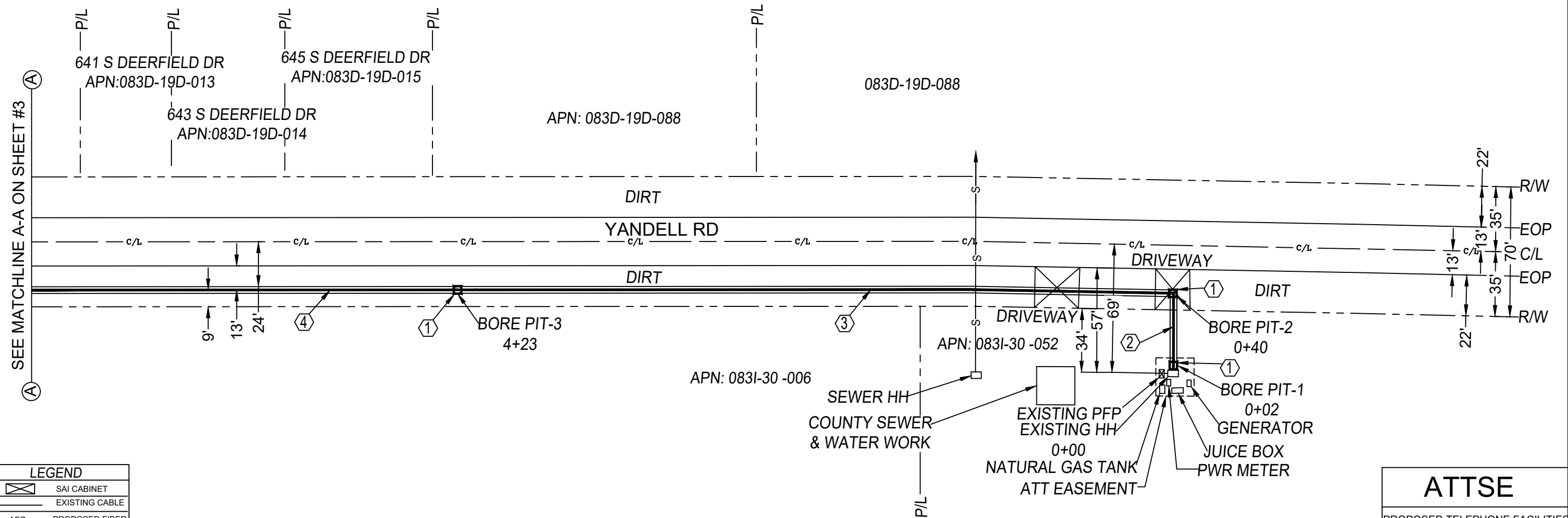

LEGEND	
	SAI CABINET
	EXISTING CABLE
	PROPOSED FIBER
	STREETLIGHT
	BORING
	BURIED FIBER CABLE
	TRENCH
	FIRE HYDRANT
	POLE
	MANHOLE
	ROAD SIGN
	BOLLARD
	POTHOLE
	FENCELINE
	TREE
	HEDGE
	DIG PIT

UTILITIES	
	WATER
	TELEPHONE
	ELECTRIC
	SANITARY SEWER
	STORM DRAIN
	GAS
	WATER VALVE
	WATER METER

ROW	RIGHT OF WAY
FOC	FACE OF CURB
BOC	BACK OF CURB
LOG	LIP OF GUTTER
FOW	FRONT OF WALK
BOW	BACK OF WALK
EOD	EDGE OF DRIVEWAY
EOW	EDGE OF WALKWAY
SW	SIDEWALK
PL	PROPERTY LINE
DW	DRIVEWAY
C/L	CENTERLINE

NOTE: MAINTAIN 3' VERTICAL AND 5' MIN. HORIZONTAL SEPERATION WITH ALL WATER AND SEWER UTILITIES.

NOTE : BACKFILL & RESTORE DIRT SURFACE AS PER COUNTY STANDARDS.

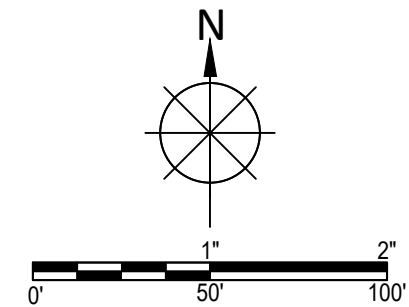

ATTSE
PROPOSED TELEPHONE FACILITIES ON RIGHT OF WAY OF MADISON COUNTY
F 100 WOODGATE BLVD
NPANNX: 601856
Designer: MIZELL DAVID
Phone: (601) 859-3307
Authorization: A02KKWC
Dwg. 2 of 4

PLACEMENT CALLOUTS

- ① DIG 4' X 4' BORE PIT-4 & BORE PIT-5 IN DIRT SURFACE.
- ④ BORE FROM BORE PIT-3 TO BORE PIT-4 AND PLACE ±383' OF 1-1.5" INNERDUCT AT DEPTH 36".
- ⑤ BORE FROM BORE PIT-4 TO NEW HH (BORE PIT-5) AND PLACE ±384' OF 1-1.5" INNERDUCT AT DEPTH 36".

- ⑥ PLACE NEW HH (30X48X36).
- ⑦ TRENCH FROM NEW HH TO NEW 864 PFP AND PLACE ±3' OF 1-4" PVC AT DEPTH 32". (CABINET DETAILS ON DWG.04)
- ⑧ PLACE AT&T NEW 864 PAD MOUNT PFP (42.8"W X 40.5"H X 19.9"D) ON NEW CONCRETE PAD (4'X5'). (CABINET DETAILS ON DWG.04)



ISSUE	DATE
0	06-20-23

LEGEND	
	SAI CABINET
	EXISTING CABLE
	PROPOSED FIBER
	STREETLIGHT
	BORING
	BURIED FIBER CABLE
	TRENCH
	FIRE HYDRANT
	POLE
	MANHOLE
	ROAD SIGN
	BOLLARD
	POTHOLE
	FENCELINE
	TREE
	HEDGE
	DIG PIT
	ROW RIGHT OF WAY
	FOC FACE OF CURB
	BOC BACK OF CURB
	LOG LIP OF GUTTER
	FOW FRONT OF WALK
	BOW BACK OF WALK
	EOD EDGE OF DRIVEWAY
	EOW EDGE OF WALKWAY
	SW SIDEWALK
	PL PROPERTY LINE
	DW DRIVEWAY
	C/L CENTERLINE
UTILITIES	
	W WATER
	T TELEPHONE
	E ELECTRIC
	S SANITARY SEWER
	SD STORM DRAIN
	G GAS
	○ WATER VALVE
	□ WATER METER

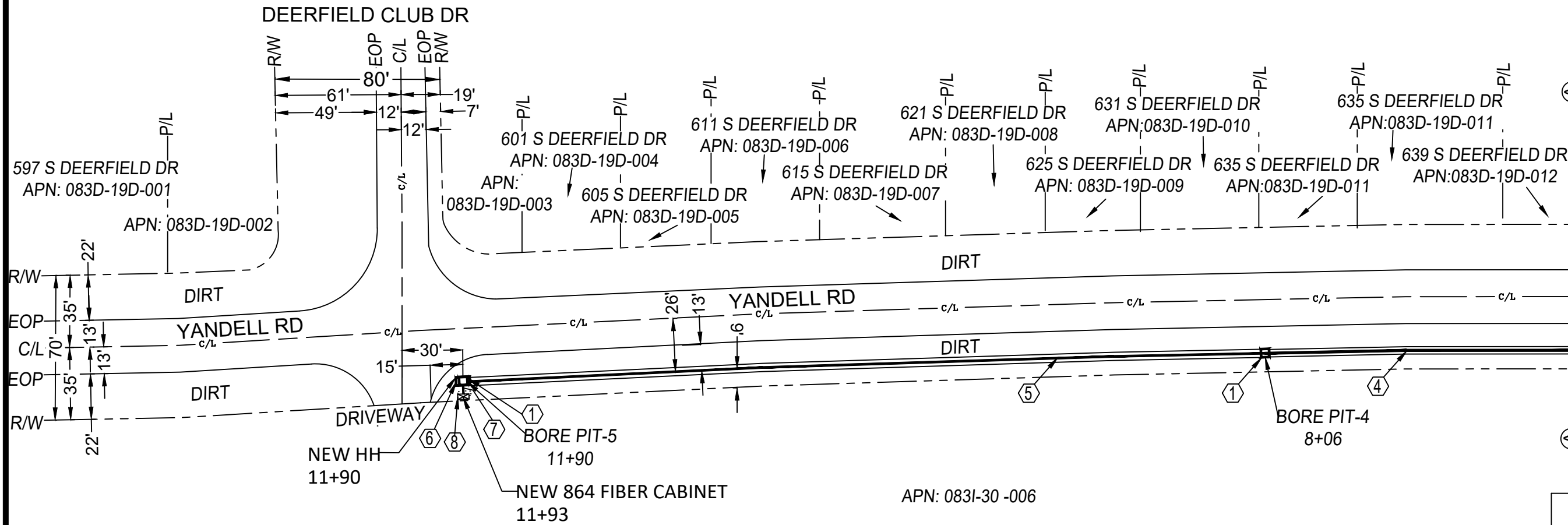

NOTE : BACKFILL & RESTORE DIRT SURFACE AS PER COUNTY STANDARDS.

NOTE: MAINTAIN 3' VERTICAL AND 5' MIN. HORIZONTAL SEPERATION WITH ALL WATER AND SEWER UTILITIES.

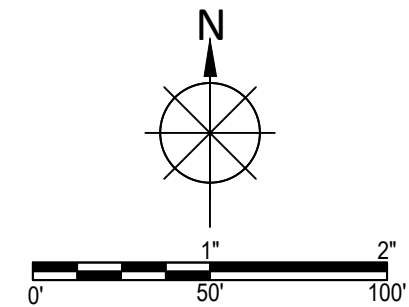

ATTSE	
PROPOSED TELEPHONE FACILITIES ON RIGHT OF WAY OF MADISON COUNTY	
F 100 WOODGATE BLVD	
NPANNX:	601856
Designer:	MIZELL DAVID
Phone:	(601) 859-3307
Authorization:	A02KKWC
Dwg. <u>3</u> of <u>4</u>	

864F CABINET DETAILS AND NOTES



ISSUE	DATE
0	06-20-23

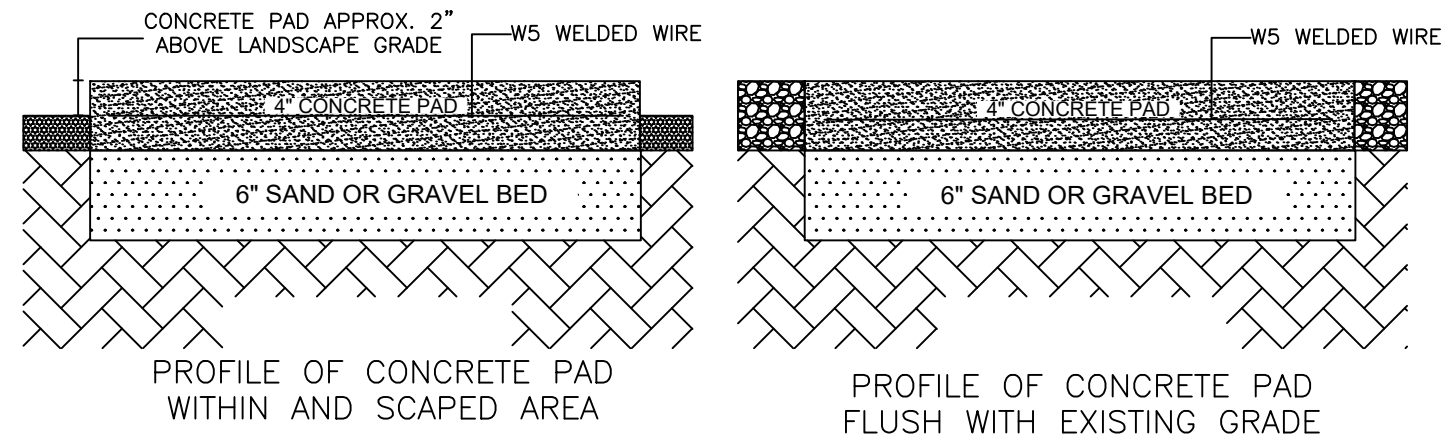
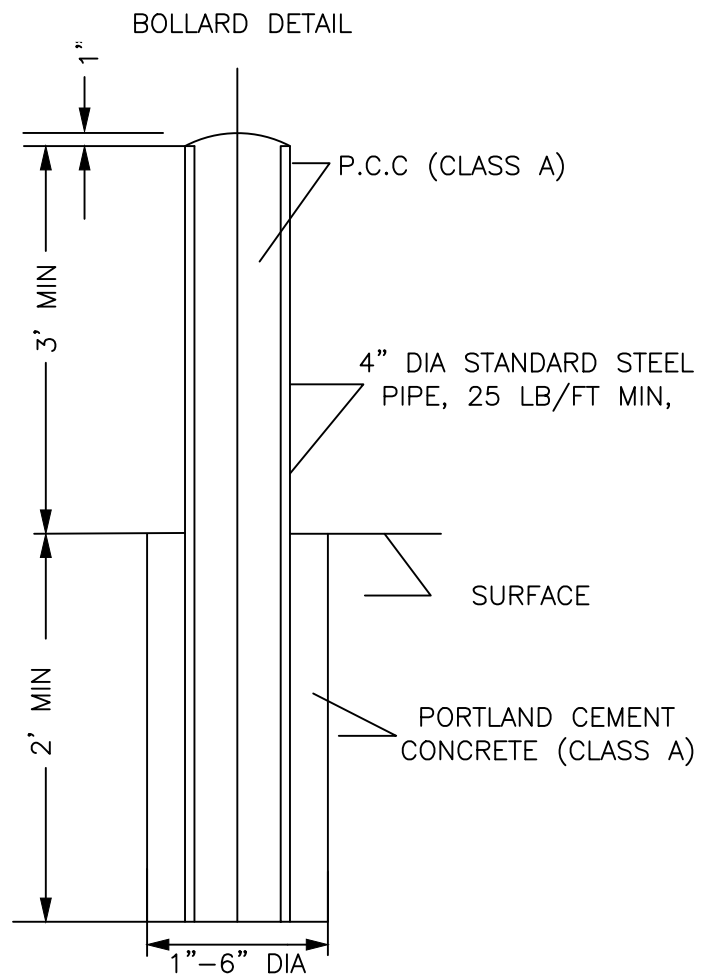

864F CABINET DETAILS

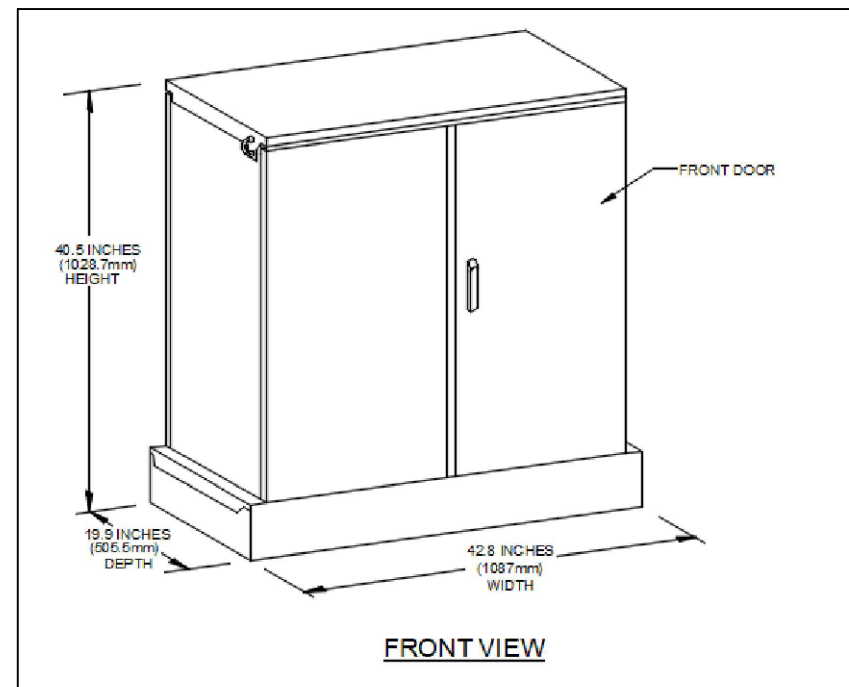

ATTSE	
PROPOSED TELEPHONE FACILITIES ON RIGHT OF WAY OF MADISON COUNTY	
F 100 WOODGATE BLVD	
NPANNX:	601856
Designer:	MIZELL DAVID
Phone:	(601) 859-3307
Authorization:	A02KKWC
Dwg.	4 of 4